



Our
Baby

Clifford Vere Lumsdaine - Baby Book
Written by
Arthur Henry Vere Lumsdaine

Our



Baby

Clifford Vere Lumsdaine - Age one

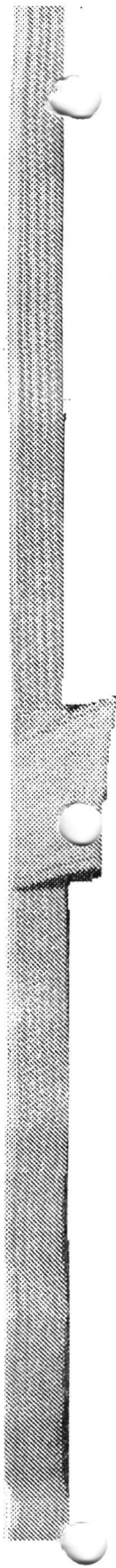

Baby's Name

Clifford Lee Lumsdaine

Born

November 6th 1909

2. A. M.

Place of Birth

Seattle General Hospital

Seattle, Washington
U. S. A

Baby's Weight

4 pounds

Baby's Height

Baby's Parents

Mary Ellen Margaret
Lumsdaine

Arthur Henry Vere Lumsdaine

Grandparents

Baby's first Laugh

Gifts

Baby's first Outing

Ride home from Hospital
to 4008 Denmore Ave
our home November 16th 1909.

Baby's first Tooth



4008 Densmore, Seattle, Washington (CVL's first home 1909)
Photo taken August, 1992 by C. J. Lumsdaine

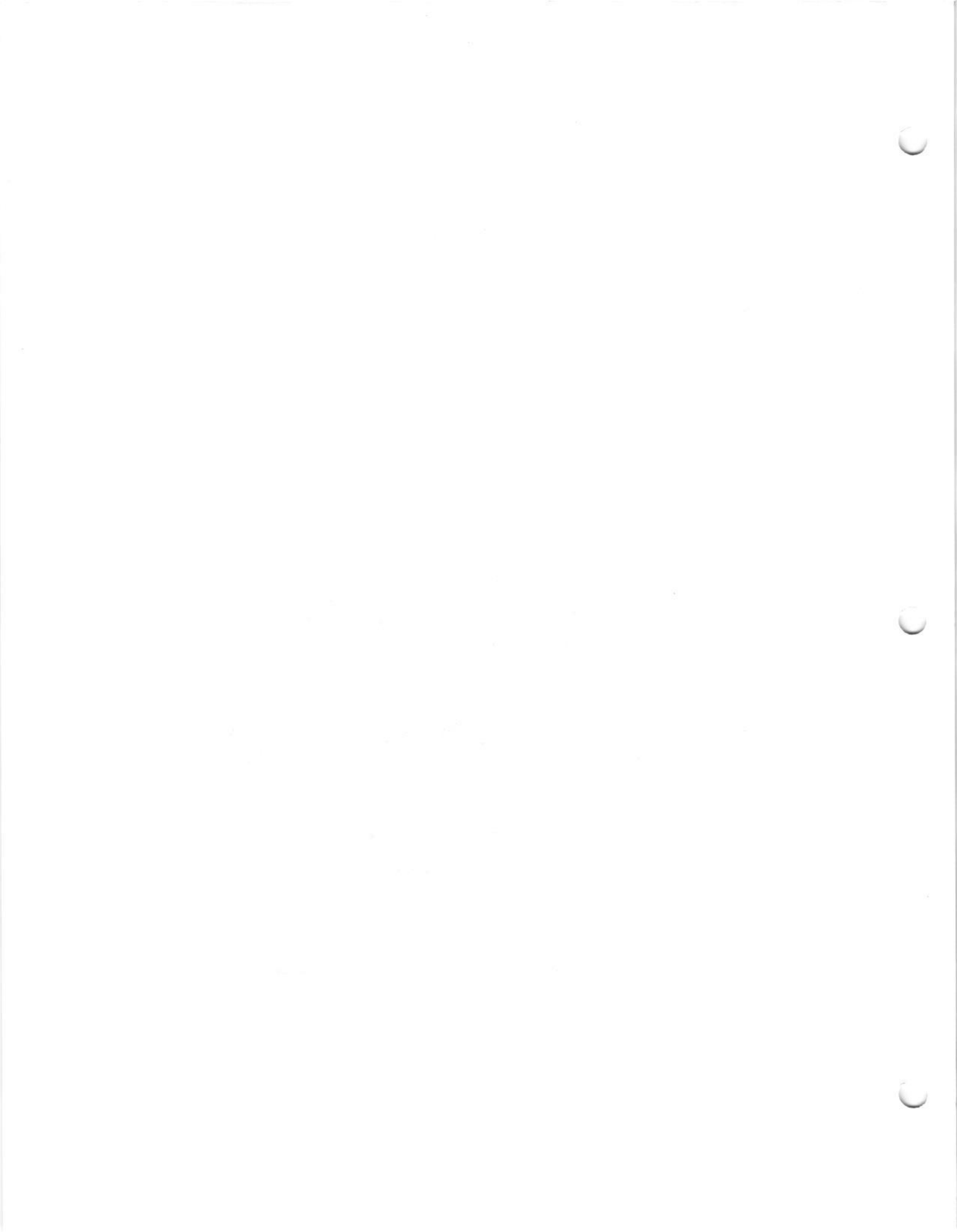

Baby's first Shoes

First short Clothes

Baby's first picture

1 Year old

November 6th 1910.

Baby's first Party

November 6th 1910

Birthday party.

Baby's first Word

"Mama" & "dada"

Baby's first Step

September 1911

He was able to walk long
before this date around the
push chairs around the
room, but made no attempt
to walk alone.

Babyhood Events

Clifford + Mother took trip
to Farmington Iowa, left
Seattle May 19th 1910, via C.P.R.
Stayed at Des Moines, and
Beatrice Nebraska. Returned
to Seattle Sept. 1910.

Had photos taken when 18
~~months~~ months old.

Helga + Jack came to visit
us in October 1910.

Clifford's first Christmas Tree
Xmas 1910 when this book
was given to him by his
beloved Mother.
2nd Birthday party Nov 6th 1911

Clifford & Mother & Father
had photos taken together
first group December 5th 1911
Clifford also had his photo taken
alone same morning.

December 6th 1911. Mother became
very ill, was unconscious until
the 10th Dec., Sunday evening
when the greatest loss & most
terrible calamity of baby's life
occurred - the death of his
devoted Mother, who loved
him as no other human
being could, and who watched
over him so carefully and
tenderly from the time of his
birth.

Started to feed himself with
spoon during time he was
taken care of soon after his
Mother died & learnt to drink

at of cup above.

~~at of cup above.~~

visited Mother's grave in Calvary
cemetery Christmas morning 1911
& left some flowers on grave.

Had 2nd Christmas Tree and
received several nice presents.

Mrs. Murray came to take charge
of baby Dec. 20th 1911.

Jack Murray & Clifford had
Christmas tree together.

Clifford gained in weight
nearly four pounds from Xmas
to Mar 6th 1912 & looked much
better.

March 9th 1912

Weight 23 pounds

Height 32 inches

Measurement of Head 19 $\frac{1}{2}$ inches

" " Chest 19 $\frac{1}{4}$ "

" " Thigh 11 "



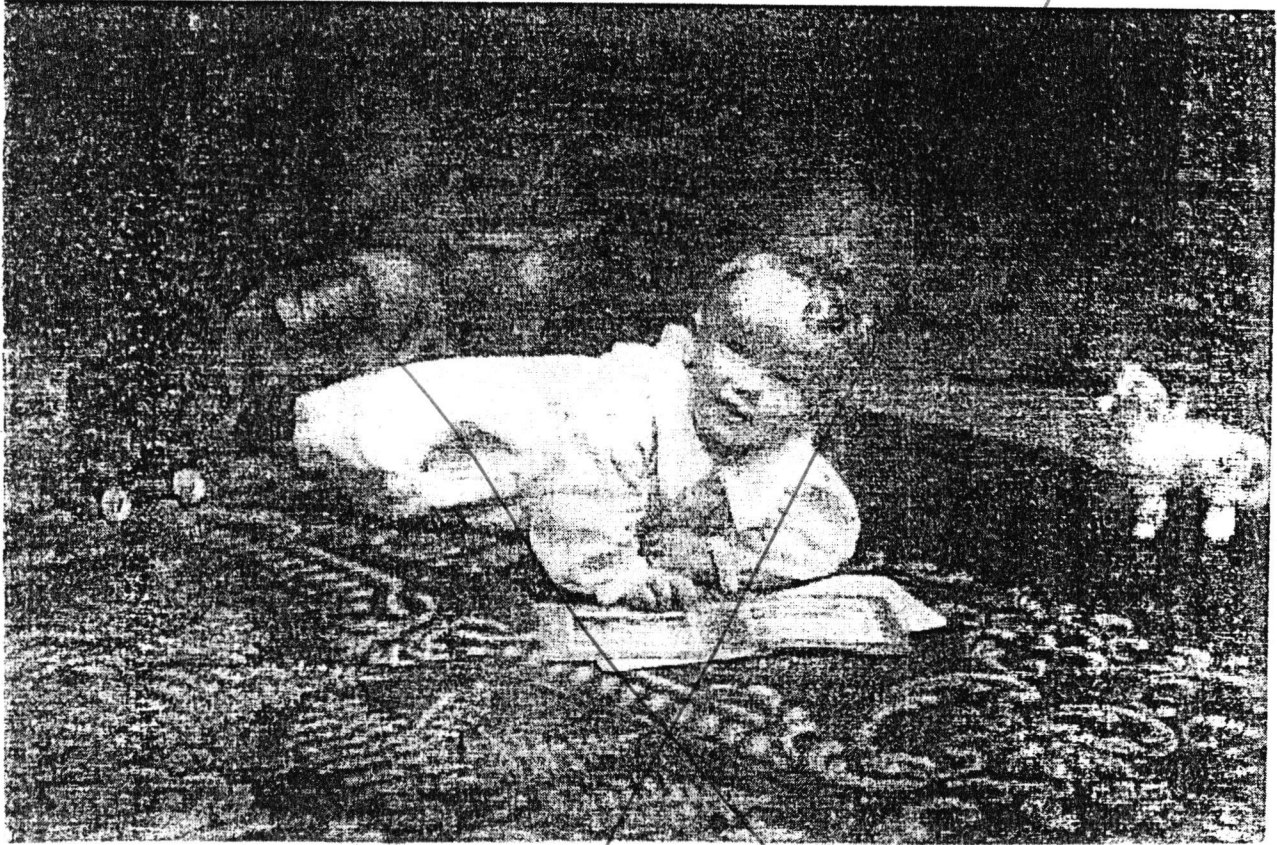

CLIFFORD VERE LUMSDAINE - AGE 18 MONTHS

Feb 6th 1913

Clifford found a new Mother, a good true woman who took him to her heart and loved him as her own.

It was a grand day for Clifford and may God bless his noble new Mother for her kindness and love.

Nov 23rd 1913

Clifford found a baby to sleep and long may they love and play together.

May God bless
and guide our little
family. May he
strengthen us to resist
temptation and evil
so that all of us may
learn to love and
obey to follow in
his footsteps.

To the mother of my
babies I hand this
little book for safe
keeping Sept. 6th 1914
Arthur

MARRIAGE RECORD, VAN BUREN COUNTY.

Day, Eberle, & Eldlar, Davenport.

MARRIAGE LICENSE.

Office of Clerk of Circuit Court,

STATE OF IOWA, Van Buren County, ss:

License is hereby Granted to any person authorized to solemnize Marriages according to the Laws of said State, to JOIN IN MARRIAGE Mr Daniel Clifford and Miss Mary Buchanan of the County aforesaid; and the person joining them in marriage is also required to make due return of the Certificate annexed to the Circuit Court, within ninety days, of the names of the parties, time and place of marriage, and by whom solemnized.

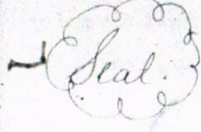

IN TESTIMONY WHEREOF, I have hereunto set my hand and affixed the seal of said Court, at my office in Quincy in said County, this 28 day of December A. D. 1874

James Johnston
Clerk Circuit Court.
J. W. Mathews Deputy

CERTIFICATE OF MARRIAGE.

To the Circuit Court of Van Buren County:

This Certifies, That on the 4 day of January A. D. 1875, at Quincy in said County, according to law and by authority, I duly

JOINED IN MARRIAGE Mr Daniel Clifford and Miss Mary Buchanan

Given under my hand the 21 day of April A. D. 1875

Rev. C. J. Morrison

all spelled Buchanan

SEATTLE-KING COUNTY
DEPARTMENT OF PUBLIC HEALTH
VITAL STATISTICS DIVISION
900 Public Safety Building, Seattle 4, Washington

CERTIFIED COPY OF DEATH CERTIFICATE

Place of Death

County of King
City of Seattle

Volume No. 1911
Register No. 2287

Registration Dist. No. No. 4008 Densmore
(If death occurred in a hospital or institution, give its NAME instead of street and number)
2. FULL NAME MARY ELLEN MARGARET LUMSDAINE
(a) Residence No. St.;
(Usual place of abode)
(b) If non-resident, give city or town, and state
(c) How long in Registration Dist. yrs. mos. ds.; how long in U. S. if of foreign birth yrs. mos. ds.

3. SEX F	4. COLOR OR RACE White	5. Single, Married, Widowed, or Divorced (Write the word) Married
6. (a) If married, widowed, or divorced: Husband of _____ or Wife of _____		
7. Date of birth March 2 1881 (Month) (Day) (Year)		
8. Age 30 yrs. 9 mos. 8 ds. hrs. or min. If less than one day		
9. Occupation of deceased: (a) Trade, profession, or particular kind of work Housewife (b) General nature of industry, business, or establishment in which employed (or employer) (c) Name of employer		
10. Birthplace (City or Town) (State or Country) Iowa		
PARENTS	11. Name of Father	
	12. Birthplace of Father (City or Town) (State or Country) Ire.	
	13. Maiden name of Mother Unknown	
14. Birthplace of Mother (City or Town) (State or Country) Ire.		
15. Informant G. M. Butterworth Address 1921 1st Ave.		
16. Filed Dec. 11, 1911 J. E. Crichton Registrar.		

Medical Certificate of Death

16. Date of Death December 10 1911
(Month) (Day) (Year)

17. I HEREBY CERTIFY, That I attended deceased from Dec. 6, 1911 to Dec. 10, 1911 that I last saw her alive on Dec. 10, 1911 and that death occurred on the date stated above, at 8 P. M. m. (State the disease causing death, or, in deaths from violent causes, state: (1) Means and nature of injury; and (2) whether ACCIDENTAL, SUICIDAL, or HOMICIDAL).
The CAUSE OF DEATH was as follows:
(Primary) Diabetes Mellitus
(Secondary) Said to be a (Duration) of 3 yrs. mos. ds. CONTRIBUTORY Coma (Duration) 3 days mos. ds.

18. Where was disease contracted if not at the place of death?
(a) Did an operation precede death? Date of _____
(b) Was there an autopsy?
(c) What test confirmed diagnosis?
(Signed) R. France M. D.
Dec. 11 1911 Address Seattle

19. Place of Burial, Cremation or Removal Calvary Date of Burial Dec. 12 1911

20. Undertaker Butterworth & Sons Address Seattle

I HEREBY CERTIFY, That the foregoing is a true, full and correct copy of the certificate of death of

MARY ELLEN MARGARET LUMSDAINE
on file in this office.
S. P. P. Luman M.D.
Seattle-King County Registrar

By Joan Cable
Seattle, Wash., April 13, 1953

ST. LOUIS - MO
SEP 10 1900



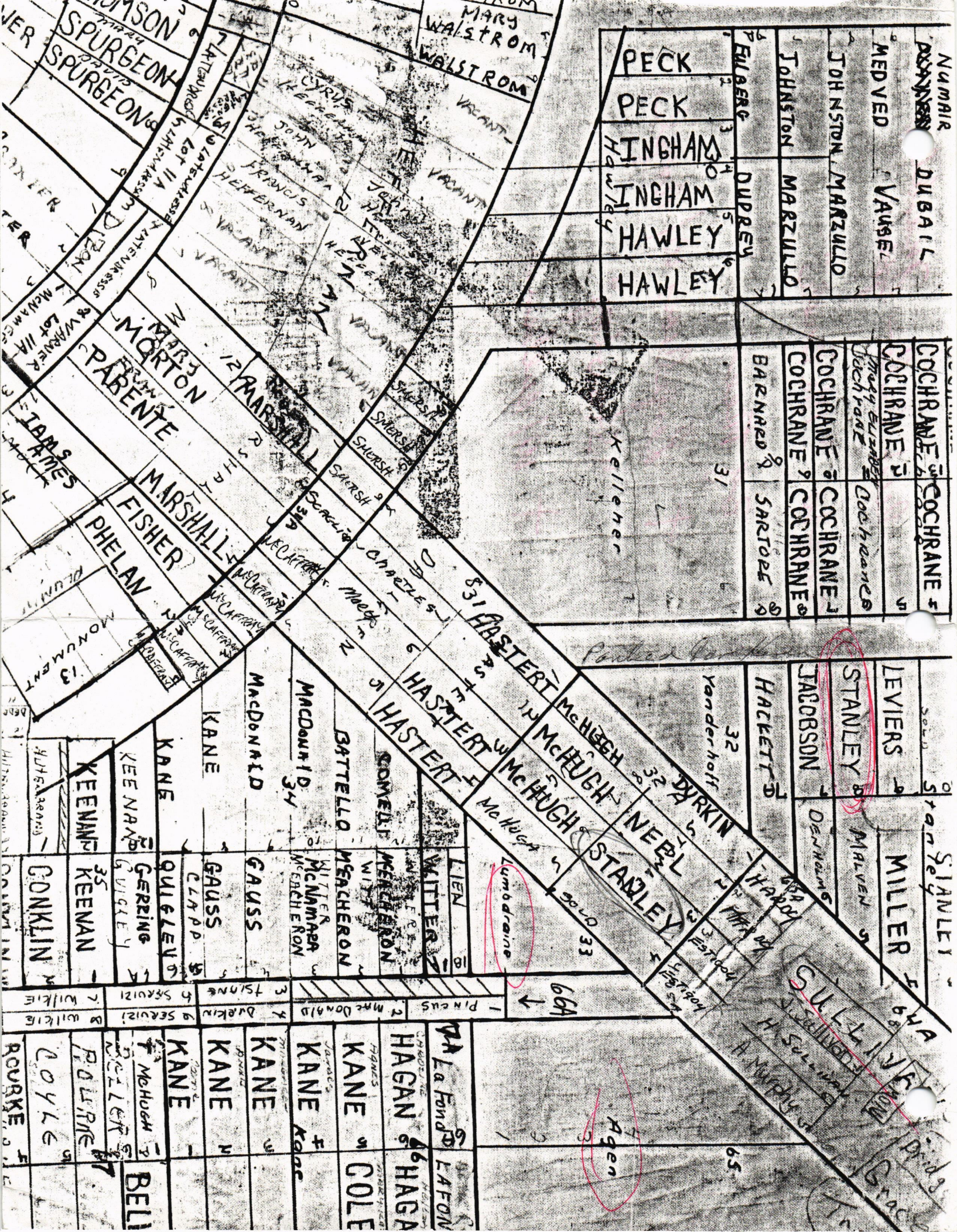

NUMAIR
DUBAIL

MEDVED
VAUSEL

JOHNSTON
MARZULLO

JOHNSTON
MARZULLO

FULBERG
DUPREY

PECK
PECK
INGHAM
INGHAM
HAWLEY
HAWLEY

COCHRANE
COCHRANE

COCHRANE
COCHRANE

COCHRANE
COCHRANE

COCHRANE
COCHRANE

COCHRANE
COCHRANE

BARNEED
SARTOPE

STANLEY
STANLEY

LEVIERS
MILLER

STANLEY
MALVEN

JACOBSON
DENHAM

HACKETT
HARDY

Yanderhoff
DYRKIN

NEEL
NEEL

STABLEY
STABLEY

McHUGH
McHUGH

McHUGH
McHUGH

McHUGH
McHUGH

HASTERT
HASTERT

HASTERT
HASTERT

HASTERT
HASTERT

BATELLO
MEACHERON

McDONALD
McDONALD

McDONALD
McDONALD

KANE
GAUSS

KANE
GAUSS

KANE
GAUSS

KEENAN
GERING

KEENAN
GERING

CONKLIN
CONKLIN

SULLIVAN
SULLIVAN

SULLIVAN
SULLIVAN

SULLIVAN
SULLIVAN

SULLIVAN
SULLIVAN

SULLIVAN
SULLIVAN

SULLIVAN
SULLIVAN

SULLIVAN
SULLIVAN

SULLIVAN
SULLIVAN

SULLIVAN
SULLIVAN

SULLIVAN
SULLIVAN

SULLIVAN
SULLIVAN

SULLIVAN
SULLIVAN

SULLIVAN
SULLIVAN

SULLIVAN
SULLIVAN

SULLIVAN
SULLIVAN

SULLIVAN
SULLIVAN

SULLIVAN
SULLIVAN

SULLIVAN
SULLIVAN

SULLIVAN
SULLIVAN

SULLIVAN
SULLIVAN

SULLIVAN
SULLIVAN

SULLIVAN
SULLIVAN

SULLIVAN
SULLIVAN

SULLIVAN
SULLIVAN

SULLIVAN
SULLIVAN

Agen

664

655

LA FONDS LA FON

HAGA HAGA

KANE COLE

KANE KANE

KANE KANE

KANE KANE

KANE KANE

KANE KANE

COYLE BELI

ROURKE

Rest Color ~~Green~~ Marked -

next to "Mc Bush"

Big Tree

+ Large Cross w/ Angel

"Star-Log"

+ w/ Sullivan.

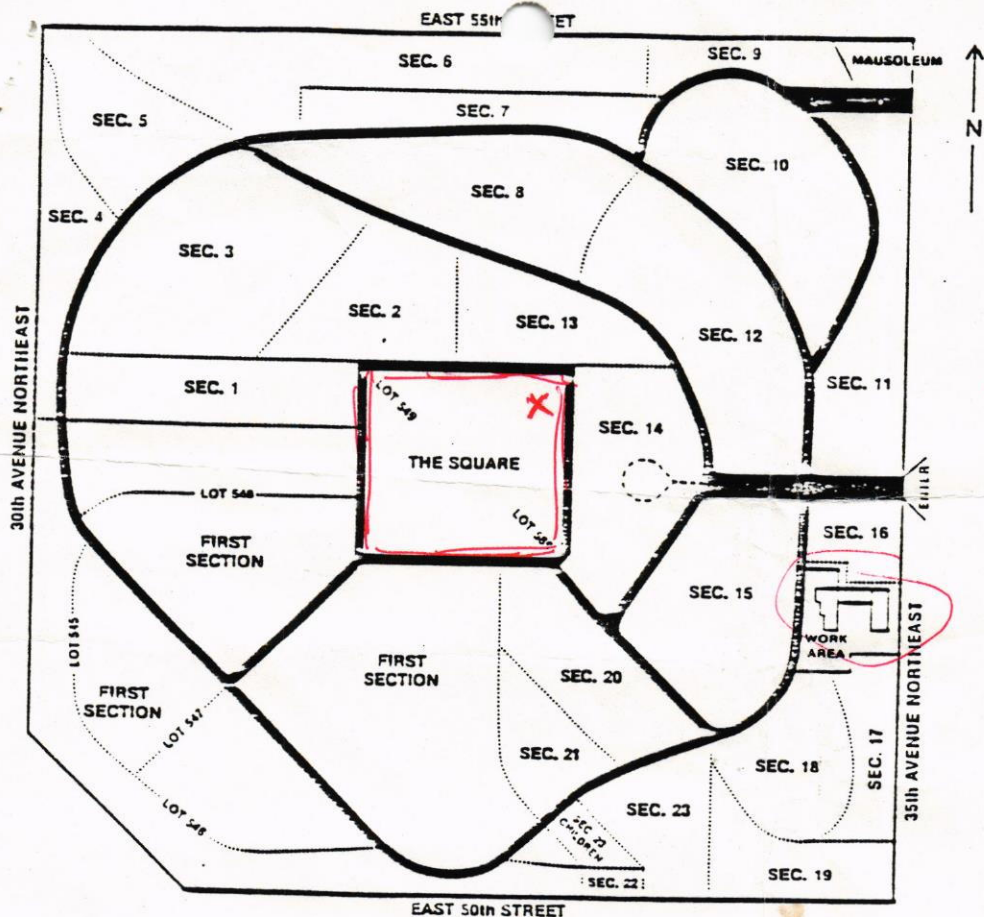

BURIAL RECORD OF:

NAME MARY ELLLEN LUMSKAINE

GRAVE 1 LOT 33 SECTION First

DOF BURIAL
DEC. 1911

CALVARY CEMETERY

Archdiocese of Seattle
5041 35th Avenue N.E.
Seattle, Washington 98105
(206) 522-0996

Office Hours:

Monday through Friday 8:00 A.M. to 3:30 P.M.
Saturday 8:00 A.M. to 2:30 P.M.
Closed on Legal Holidays

Cemetery Visiting Hours:

October through April: 8:00 A.M. to 4:30 P.M.
May through September: 8:00 A.M. to 8:00 P.M.

BEHAT RECORD FOR
NAME: MARY ELLEN LAMBRINE
GRADE: 1 FOR 33 PAGES

Doc. 1411
Dot Barua



Maximize the efficiency of the
Grand Inland Area 800 A.M. 1 to 2
County Working Paper
Grant in the amount of \$100,000
to the State of Alaska
Department of Education
1941-1942
State Department of Education
100
100
100